

# Manual - EGT + Boost & EGT



## ⚠ WARNING - Please Read Entire Manual Carefully!

- Do not change settings while driving.
- This product is designed to work with 12 Volt (v) vehicles only! This product will not operate on 6v or 24v systems.
- Please have this product installed by store or dealer where product was purchased. Installation by the customer will void the warranty.
- Do not disassemble or modify this product. Such actions will not only void the warranty, but may also damage or destroy the product.
- Do not perform installations of this product immediately after the engine has been switched off. The engine and exhaust system are extremely hot as this time and can cause burns if touched.

## ➔ Main Features

- ✨ High quality and accurate boost pressure and EGT temperature sensors
- 🔋 Onboard memory battery. Gauge will retain settings even after being disconnected from the vehicles battery.
- 📺 High contrast vertical aligned Liquid Crystal Display (LCD), no shadows when backlight is turned off. Different colour values can be chosen for night and day running mode.
- ⚠ Warning values can be programmed to trigger a warning busser with 3x different chimes.
- 🔊 The warning buzzer can be set 4x different sound levels: Off, low, medium, high.
- 🌞 Brightness can be set to 5 different values. For both night and day running mode.
- ❤️ 3x different movements can be set for indicator display type.
- 🏔 Peak values obtained during operation will be stored, this can be reviewed and cleared at a later time (value will remain stored between engine cycles or trips).

## 📦 What's Included In Your Kit?

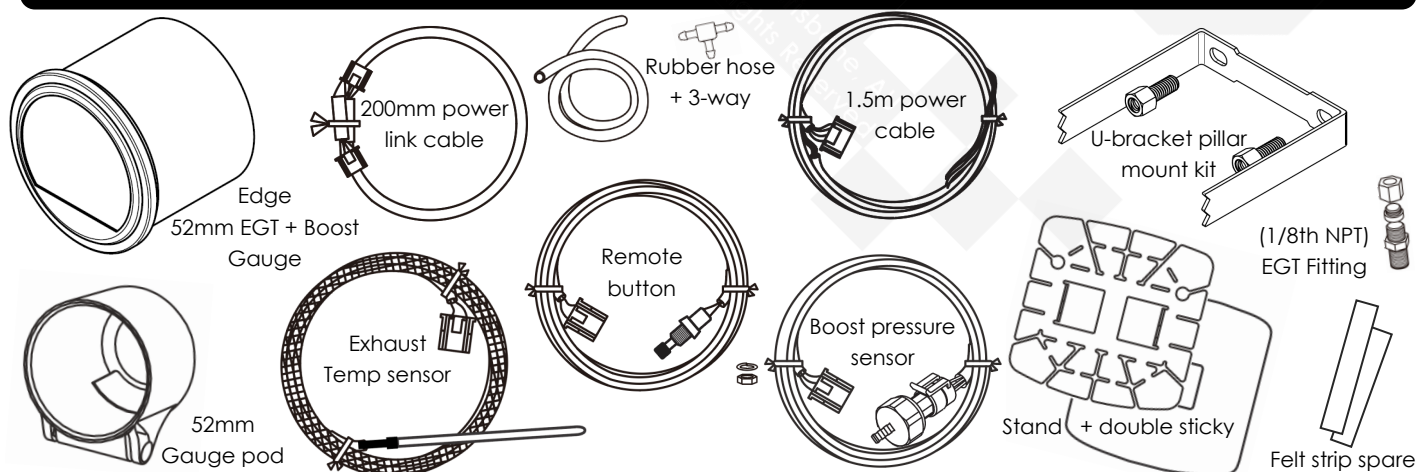

## 📖 Gauge Specifications

- Power-supply voltage:  
10v to 15v DC (12v vehicles only)
- Current consumption:  
+B line: MAX 120mA  
IGN line: MAX 120mA  
ILM line: MAX 2mA

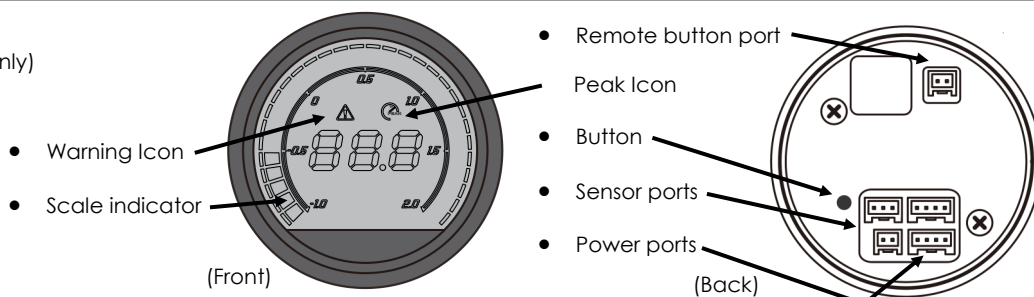

## ⚡ How To Connect Your Wiring

- Disconnect the negative terminal on the battery. Connect the power wires as shown. Warning! Always install a fuse where +12v is indicated.
- Connect the EGT and Boost sensor wires to their respective harnesses. Follow procedure below for sensor specific installation.
- (Optional) Install remote button wire and connect to the gauge.
- Install 1x felt sticky strip (supplied) on inside edge of gauge pod.
- Reconnect negative battery wire and start using the gauge

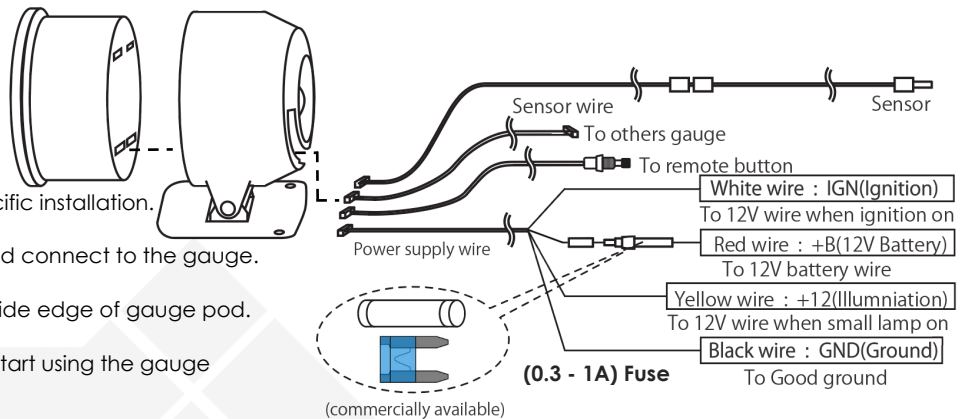

## 🔧 Install Exhaust Gas Temperature Sensor

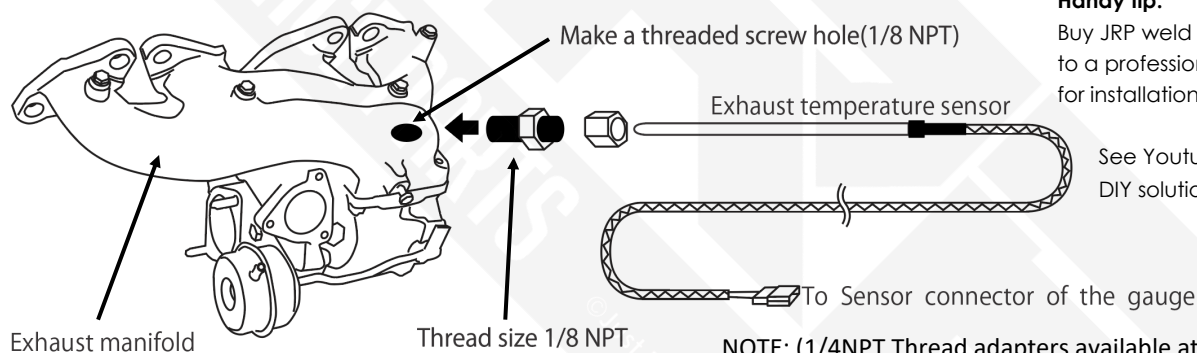

### Handy tip:

Buy JRP weld in bung and take to a professional exhaust shop for installation.

See Youtube.com for other DIY solutions! 🤖

NOTE: (1/4NPT Thread adapters available at JRP)

## 👉 Correct Boost Sensor Installation

- JRP boost pressure sensors read "absolute atmospheric pressure." These are very high quality and rarely fail if installed correctly. The "barb" from the sensor should be installed in a way that it is self draining so that: oil, dirt and moisture don't collect on the internals. Ignoring this will lead to premature failure, and may not be covered by factory warranty.

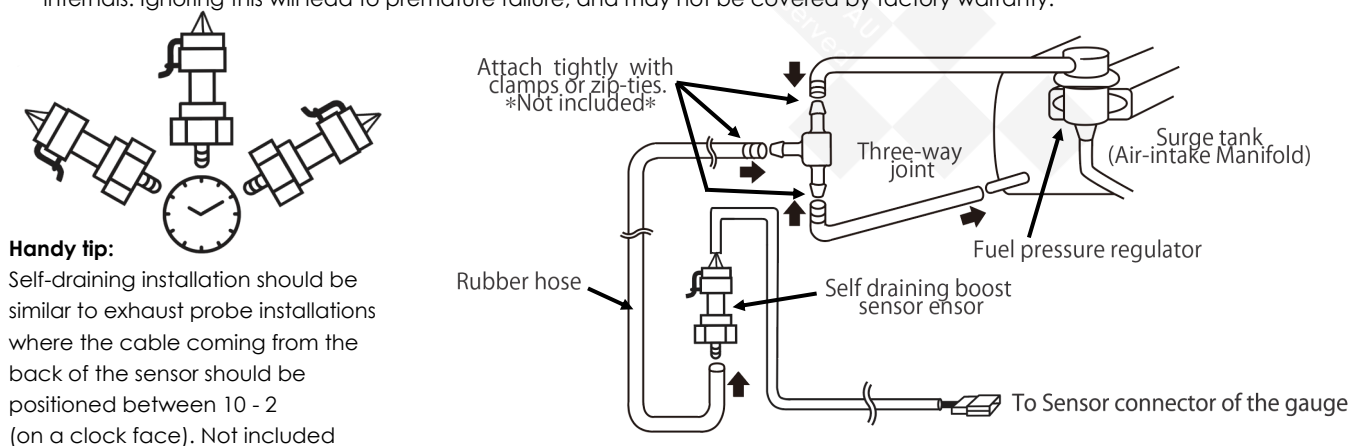

### Handy tip:

Self-draining installation should be similar to exhaust probe installations where the cable coming from the back of the sensor should be positioned between 10 - 2 (on a clock face). Not included

## 🔧 Calibrate Boost Sensor

- Because of the nature of the sensor reading absolute atmospheric pressure your gauge out of the box might read a positive or negative value number when the engine isn't running. (This is quite normal). Atmospheric pressure will read different values between sea level and your location.

For an accurate boost reading its important to calibrate the pressure offset on your gauge. Note: there are two units of measurement that can be used for boost sensor calibration: BAR and PSI. (Offset calibration will have to be adjusted depending on the gauge mode chosen in the initial setup). The goal here is to get the boost gauge to display 0.0BAR or 0.0PSI when the engine isn't running. Follow the "BAR or PSI Offset Calibration" procedure in the detailed button operation on page 5.

# Manual - EGT + Boost & EGT



Introducing

New



**CPW**  
COLOUR PRE-WARN

- Colour Pre-warn (CPW) is a new innovation developed first in the world by Just Race Parts. The new Version 1.5v - Edge series temperature gauges, now have a two stage warning system. One which works the same as old/ competitor gauges where you set a warning value that can trigger an alarm on the gauge. Now with the CPW feature enabled; the gauge will change display colours leading up to your set warning alarm.

You can set custom colours as well as the pre-set adjustable number increments.

See example below: **Blue** is your "day mode" running colour, **500c** is your warning alarm trigger value **20** is your temperature control increment.



Temperature below 440 display colour says to:  
(Mode set colour)



Temperature above 440 display colour change to:  
(Yellow default)



Temperature above 460 display colour change to:  
(Orange default)



Temperature above 480 display colour change to:  
(Red default)



Temperature above 500 display warning  $\Delta$  sound  
buzzer alarm

- To enable this feature navigate to temperature control marked as "TC" in the menu. Long press to make changes (off is default). The values available for EGT based gauges are 20,30,40.

## Gauge Mode Configuration

There are 4x different display modes available for the EGT and Boost + EGT 52mm Edge series gauges

- TY1 - Volts + EGT:** This display mode will show Volts as the numeric readout in the centre of the gauge, and the outside scale type readout as Exhaust temperature.
- TY2 - Boost BAR + EGT:** This display mode will show Boost as the numeric readout in the centre of the gauge in BAR, and the outside scale type readout will be EGT's.
- TY3 - Boost PSI + EGT:** This display mode will show Boost as the numeric readout in the centre of the gauge in PSI, and the outside scale type readout will be EGT's.
- TY4 - EGT Only:** This display mode will show EGT as the numeric readout in the centre of the gauge, and the outside scale type readout will also be EGT's. This is the display mode is required if only displaying EGT Data.
- Note: The Edge 52mm EGT only gauge, is actually the Edge Dual function gauge (just shipped without the Boost sensor). For EGT only customers you will need to change your display mode to EGT + EGT or Volts + EGT after installing. If at any point you would like to add a Boost sensor to your EGT gauge to make it Dual function, you can purchase the "7 BAR" boost sensor from us at a later date and simply connect it to the gauge followed by changing your display mode to Boost + EGT.

## Peak Value/ Combo Gauges

- While the gauge is running it will record peak data values coming in from all sensors connected to the gauge. The value that's displayed in the peak menu is what is shown in the centre numerical screen.

Say for example you're running "Boost PSI & EGT- display mode" (TY3). It will display the Boost peak (As that's what's displayed in the centre numerical screen). The peak EGT value will still be recorded and saved - (equally the alarms for EGT Temperatures will still trigger). But you won't be able to see EGT peak values in display mode (TY3).

You can however change the display mode to EGT only (TY4) and then check the peak value from there. Clear or leave the value recorded then change back to display mode TY3 to bring the boost display back.

# Manual - EGT + Boost & EGT



## Common Button Operation

- To make changes to your new gauge use the button on the back of the gauge or the remote button included in each kit. (Both provide the same function). The button can be used to scroll through the menu. Short press will take you through the menu options, long press for three seconds on the displayed option will take you into the setup menu for that selection. Make adjustments to that menu option using short presses, when the setting displays the required value, wait five seconds to return to live data to be display - Saved. (this will confirm and save your set up option). See page 4 & 5 for detailed button operation.
- NOTE:** Day and night time modes can be set to display different settings shown in table below. You have to enter the night time mode to make changes to night time menus. (Night mode is triggered from a 12 volt signal input from the yellow power wire).

## Detailed Button Operation

- The table below shows what to expect when navigating your 52mm Edge series EGT & Boost + EGT gauge, this is more or less an on the fly cheat sheet to assist you during setup. Best way to understand all the features and functions is to read this whole instruction manual carefully.
- For further assistance/ trouble shooting please visit our YouTube channel:
- Visit our social platforms for new ideas, and to see our latest products:  
Alternatively send us a cheeky Dm, were here to help! 😊



CLICK ICONS TO FOLLOW LINKS

|   |     |   |  |
|---|-----|---|--|
| <b>LONG PRESS</b><br>GAUGE MODE CONFIGURATION |     | "Symbols blinking" See gauge Mode Configuration for in depth explanation on Page 3. HINT: below Each TY# value shows. V, BAR, PSI & Nothing (EGT Only).   | <b>SHORT PRESS</b><br>TY1, TY2, TY3, TY4   |
| <b>SHORT PRESS</b><br>PEAK VALUE              |     | Displays "Peak" value in current mode configuration. NOTE: All peak values are recorded.  | <b>LONG PRESS</b><br>Wait 5 sec to save<br>Clear peak value                              |
| <b>SHORT PRESS</b><br>COLOUR SELECTION        |     | <b>LONG PRESS</b><br>There are two modes for all gauges, night and day mode. Different colours can be set for each mode: Red, Green, Blue, Yellow, Purple, Snow, Mustard, Pink, Light Blue, Orange, Teal, Off, (RGB). | <b>SHORT PRESS</b><br>Day Mode<br><b>SHORT PRESS</b><br>Night Mode<br>Wait 5 sec to save |
| <b>SHORT PRESS</b><br>SCREEN BRIGHTNESS       |     | <b>LONG PRESS</b><br>There are different brightness settings available to match other instruments in your vehicle. Night and day mode can be set to different levels for each mode.                                   | <b>SHORT PRESS</b><br>Day Mode<br><b>SHORT PRESS</b><br>Night Mode<br>Wait 5 sec to save |
| <b>SHORT PRESS</b><br>BUZZER TYPES            |     | <b>LONG PRESS</b><br>There are 3 different buzzers available, gauge will display: and emit corresponding sound - Beep: slow, fast, continued...   | <b>SHORT PRESS</b><br>Types<br>no1, no2, no3<br>Wait 5 sec to save                       |
| <b>SHORT PRESS</b><br>BUZZER VOLUME           |     | <b>LONG PRESS</b><br>There are 4 sound levels: Off, 1, 2, 3.<br>Silent to loud  | <b>SHORT PRESS</b><br>Level<br>uo0, uo1, uo2, uo3<br>Wait 5 sec to save                  |
| <b>SHORT PRESS</b><br>OPEN/ CLOSE CEREMONIES  |     | <b>LONG PRESS</b><br>There are 3 options for the opening ceremony, wait for change to be saved and view while turning gauge on/ off.  | <b>SHORT PRESS</b><br>Types<br>AC1, AC2, AC3<br>Wait 5 sec to save                       |
| <b>SHORT PRESS</b><br>LOW VOLTAGE WARNING     | & V | <b>LONG PRESS</b><br>Customise the voltage(V) value to trigger alarm. Short press for fine tune adjustment, long press for rapid number adjustments.  | <b>SHORT PRESS</b><br>Voltage<br>8.0v to 18v   |

- Record the date of purchase here for warranty purposes \_\_\_\_\_.



# Manual - EGT + Boost & EGT



## Detailed Button Operation Continued...

|  |   |   |
|--|---|---|
| <b>SHORT PRESS</b><br>BAR HIGH PRESSURE WARNING  & BAR | <b>LONG PRESS</b><br>Customise the BAR pressure value to trigger alarm. Short press for fine tune adjustment, long press for rapid number adjustments.  | <b>SHORT PRESS</b><br>BAR Value<br><b>-0.99 to 7.0BAR</b>   |
| Wait 5 sec to save                                     |   |   |
| <b>SHORT PRESS</b><br>PSI HIGH PRESSURE WARNING  & PSI | <b>LONG PRESS</b><br>Customise the PSI pressure value to trigger alarm. Short press for fine tune adjustment, long press for rapid number adjustments.  | <b>SHORT PRESS</b><br>PSI Value<br><b>-15.0 to 99.9PSI</b>  |
| Wait 5 sec to save                                     |   |   |
| <b>SHORT PRESS</b><br>EGT HIGH TEMP WARNING  /EGT      | <b>LONG PRESS</b><br>Customise the Exhaust gas temperature value to trigger alarm. Short press for fine tune adjustment, long press for rapid number adjustments.   | <b>SHORT PRESS</b><br>PSI Value<br><b>300 to 999c</b>   |
| Wait 5 sec to save                                     |   |   |
| <b>SHORT PRESS</b><br>VOLTAGE OFFSET CALIBRATION  /V   | <b>LONG PRESS</b><br>This is a left over setting from the factory. Voltage calibration is disabled. (Even though it's still showing). Adjustments can be made in this menu however, the changes will not save to memory after gauge had been powered down. Specialised equipment is required to commit changes to memory. | <b>SHORT PRESS</b><br>Voltage<br><b>13.2 to 14.2v</b>   |
| Wait 5 sec to save                                     |   |   |
| <b>SHORT PRESS</b><br>BAR OFFSET CALIBRATION  /BAR     | <b>LONG PRESS</b><br>Fine tune adjustment for PSI pressure offset, aim for 0.0 BAR when engine not running.   | <b>SHORT PRESS</b><br>BAR Value<br><b>-0.66 to 0.34BAR</b><br>(PSI Equivalent)<br><b>-9.57 to 4.93PSI</b> |
| Wait 5 sec to save                                     |   |   |
| <b>SHORT PRESS</b><br>PSI OFFSET CALIBRATION  /PSI     | <b>LONG PRESS</b><br>Fine tune adjustment for PSI pressure offset, aim for 0.0 PSI when engine not running.   | <b>SHORT PRESS</b><br>PSI Value<br><b>-10.0 to 4.0PSI</b><br>(BAR Equivalent)<br><b>-0.69 to 0.28BAR</b>  |
| Wait 5 sec to save                                     |   |   |
| <b>SHORT PRESS</b><br>COLOUR TWO (CPW)                 | <b>LONG PRESS</b><br>This is where you set the first colour of the temperature-controlled colour pre-warn (CPW)<br>(YELLOW DEFAULT)   | <b>SHORT PRESS</b><br>Temperature Range   |
| Wait 5 sec to save                                     |   |   |
| <b>SHORT PRESS</b><br>COLOUR THREE (CPW)               | <b>LONG PRESS</b><br>This is where you set the first colour of the temperature-controlled colour pre-warn (CPW)<br>(ORANGE DEFAULT)   | <b>SHORT PRESS</b><br>Temperature Range   |
| Wait 5 sec to save                                     |   |   |
| <b>SHORT PRESS</b><br>COLOUR FOUR (CPW)                | <b>LONG PRESS</b><br>This is where you set the first colour of the temperature-controlled colour pre-warn (CPW)<br>(RED DEFAULT)  | <b>SHORT PRESS</b><br>Temperature Range   |
| Wait 5 sec to save                                     |   |   |
| <b>SHORT PRESS</b><br>TEMPERATURE CONTROL              | <b>LONG PRESS</b><br>This is where you can set the colour pre warn function, settings are: Off, 20, 30, & 40 for EGT.   | <b>SHORT PRESS</b><br>Temperature Range<br><b>OFF ▶ 20 ▶ 30 ▶ 40 ▶</b>                                    |
| Wait 5 sec to save                                     |   |   |
| <b>SHORT PRESS</b><br>SCALE INDICATOR                  | <b>LONG PRESS</b><br>There are 3 different indicator display types. It's best to view these options when the vehicle is up to operating temperature.  | <b>SHORT PRESS</b><br><b>So1 → So2 → So3</b>  |